

SIDE VIEW

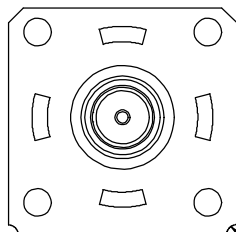

RADII AT BOTTOM

ITEM NO.	PART NUMBER	DESCRIPTION	QTY.
1	100-02193	AXLE TUBE	1
2	218-00013	SPINDLE W/FLANGE	2

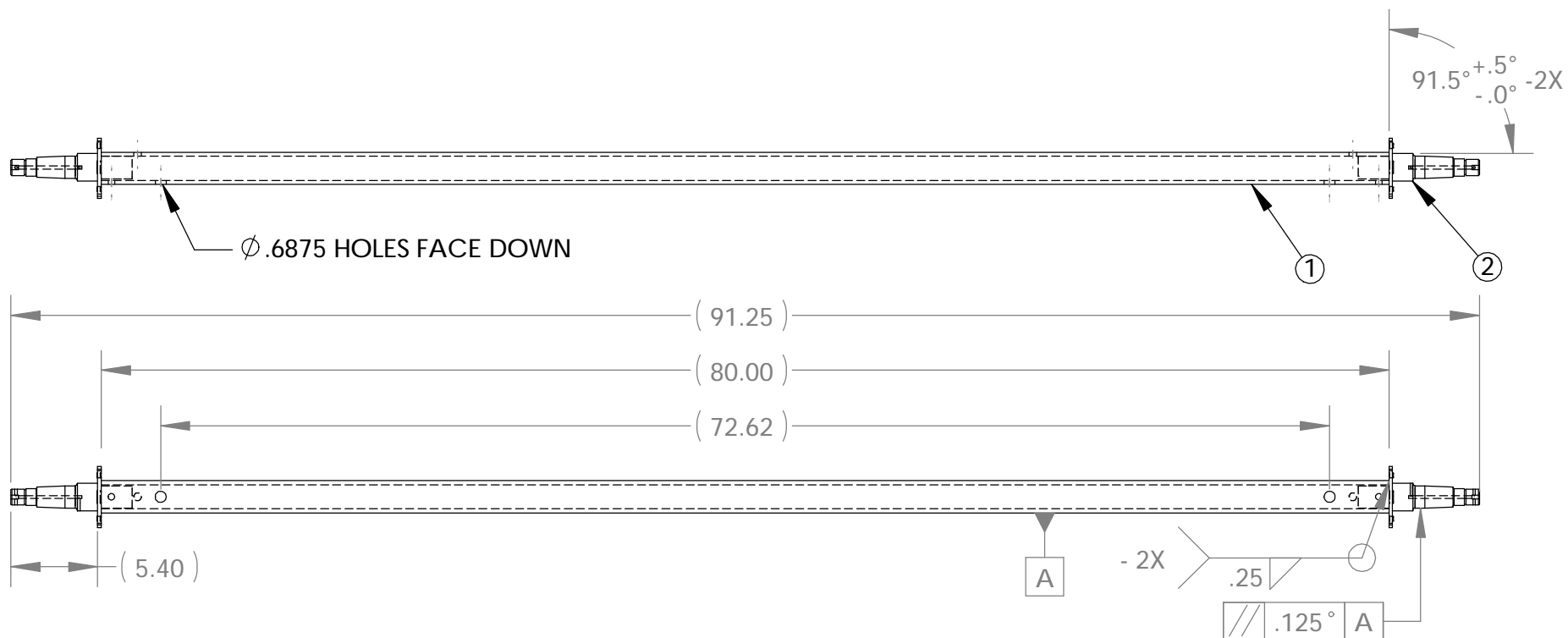

NOTES:
1.) CAPACITY: 3750#

ALL DIMENSIONS ARE IN INCHES
UNLESS OTHERWISE STATED
TOLERANCES EXCEPT AS NOTED
DECIMALS:
.X ±0.100
.XX ±0.060
.XXX ±0.030
.XXXX ±0.010

ANGLES:
±1°
ALL FORMED ANGLES
EQUAL 90° UNLESS
NOTED OTHERWISE
() INDICATES REFERENCE

THE INFORMATION IN THIS DRAWING IS THE SOLE
PROPERTY OF KARAVAN TRAILERS, INC. ANY
REPRODUCTION IN PART OR WHOLE WITHOUT
THE WRITTEN PERMISSION OF KARAVAN TRAILERS,
INC. IS PROHIBITED.
APPROVED BY:

DRAWN BY:
AMY L. GROTH
DATE:
09-30-04
SHEET:
1 OF 1
SCALE:
N/A

KARAVAN
TRAILERS

TITLE:
AXLE WELDMENT

MAT'L:
SEE B.O.M.

FINISH:
-ZN

DWG. #:
300-01517-A

DWG. REV.	ECR/NDR NUMBER	REVISED BY	DATE	DESCRIPTION
A/4	13824	CTH	04-21-08	ADDED PARALLEL GEOMETRIC TOLERANCE; REMOVE TOE-IN NOTE
A/3	14236	MJH	01-03-08	UPDATED 218-00013; ADDED SIDE VIEW

First Piece - In Process Inspection Sheet

Vendor _____

Description: **Axle Weldment**

Part # **300-01517**

Rev. **A/4**

QA Approval: S.Mudra

JOB# _____

Characteristic	Tol.	Method	Freq.	1st Piece	A/R	2	A/R	3	A/R	4	A/R	5	A/R	6	A/R	7	A/R	Inspected By/Date:
91.5° - 2X	+ .5° - .0°	Protractor	1:25															1 /
Use CF132 - 2X	NA	Visual	Every piece															2 /
Weld presence on all 4 sides	NA	Visual	100%															3 /
																		4 /
Remove all visible weld splatter, every piece	NA	Visual	Document 4x per shift															5 /
																		6 /